

## CAN bus ESD protection diode

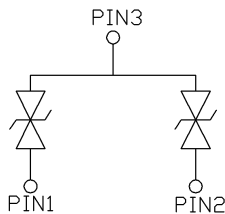

**SOT-23**



### Features

- Epoxy meets UL-94 V-0 flammability rating and halogen free
- Moisture Sensitivity Level 1
- Dual Line CAN Bus Protector for SOT-23 Package
- Max Peak Pulse Power 384W per Line (tp=8/20 μs)
- Low Clamping Voltage  $V_C=34V@I_{PP}=1A$
- IEC 61000-4-2, level 4 (ESD)
- IEC 61000-4-5 (surge),  $I_{PP} = 8A$  at  $t_p = 8/20 \mu s$
- Part no. with suffix "Q" means AEC-Q101 qualified

### Applications

- Automotive Controlled Area Network

### Mechanical Data

- **Case:** SOT-23
- **Terminals:** Tin plated leads, solderable per J-STD-002 and JESD22-B102
- **Marking:** 6R

### ■ Maximum Ratings ( $T_a=25^\circ C$ Unless otherwise specified)

PARAMETER	SYMBOL	UNIT	VALUE
Peak Pulse Power per Line (tp=8/20 μs) (Note1)	$P_{PP}$	W	384
Peak Pulse Current per Line (tp=8/20 μs) (Note1)	$I_{PP}$	A	8
Storage Temperature Range	$T_{stg}$	°C	-55 ~ +150
Junction Temperature	$T_J$	°C	-55 ~ +150
Human Body Model (HBM) (Note2)	$V_{ESD}$	kV	25
IEC 61000-4-2 (contact discharge) (Note2)		kV	30

Note1: Non-repetitive current pulse 8/20 μs exponential decay waveform according to IEC 61000-4-5.

Note2: Measured from pin 1 to 3 or 2 to 3.

### ■ Electrical Characteristics ( $T_a=25^\circ C$ unless otherwise noted)

ITEM	SYMBOL	UNIT	CONDITIONS	MIN.	TYP.	MAX.
Reverse Working Voltage	$V_{RWM}$	V		-	-	24
Reverse Breakdown Voltage	$V_{BR}$	V	$I_T=1mA$	26.3	28.3	30.3
Reverse Leakage Current	$I_R$	nA	$V_{RWM}=24V$	-	-	100
Clamping Voltage(pin 1 to 3 or 2 to 3)	$V_C$	V	$I_{PP}=1A$ (8/20μs Pulse)	-	-	34
	$V_C$	V	$I_{PP}=5A$ (8/20μs Pulse)	-	-	45
	$V_C$	V	$I_{PP}=8A$ (8/20μs Pulse)	-	-	48
Junction Capacitance(pin 1 to 3 or 2 to 3)	$C_j$	pF	$V_{BR}=0V, f=1MHZ$	-	27	32



## Ordering Information (Example)

PREFERED P/N	PACKING CODE	UNIT WEIGHT(g)	MINIMUM PACKAGE(pcs)	INNER BOX QUANTITY(pcs)	OUTER CARTON QUANTITY(pcs)	DELIVERY MODE
ESD2CAN24T2Q	F2	Approximate 0.01	3000	30000	120000	7" reel

## Characteristics (Typical)

Fig.1 8/20  $\mu$ s pulse waveform according to IEC 61000-4-5

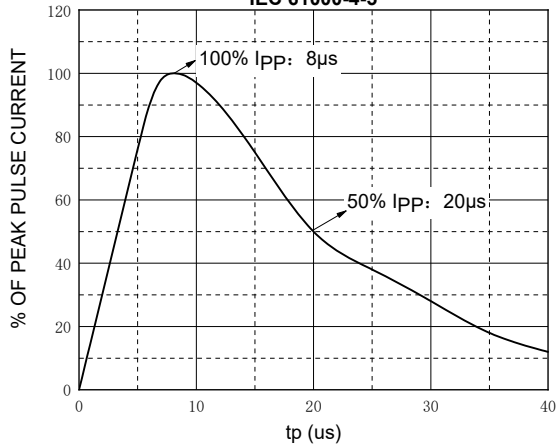

Fig.2 Clamping Voltage vs Peak Pulse Current

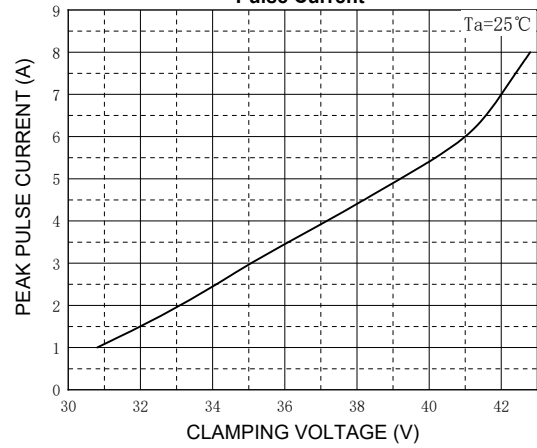

Fig.3 Temperature Power Dissipation Derating

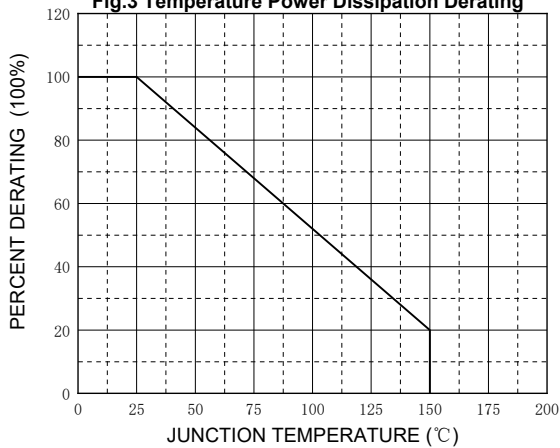
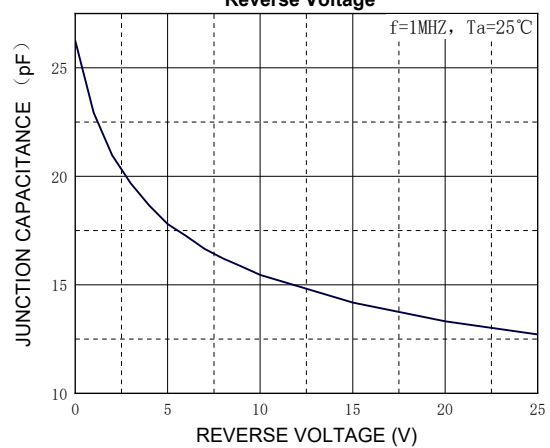
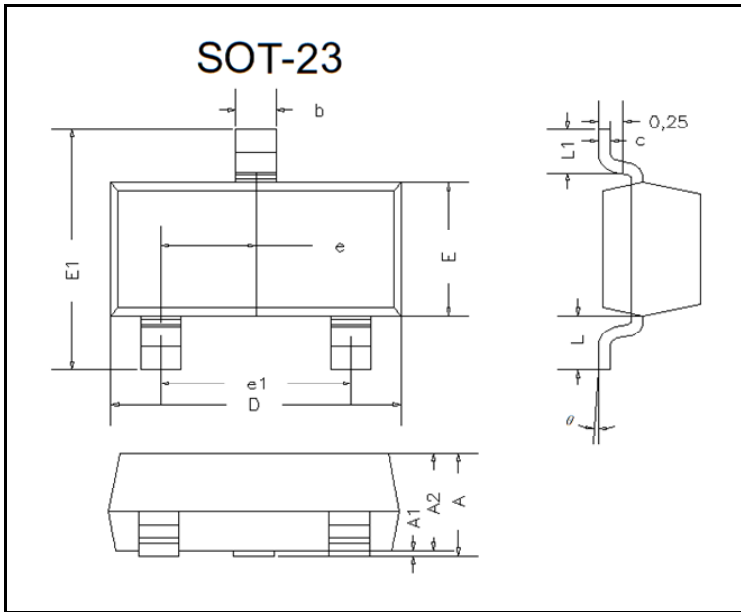

Fig.4 Typical Junction Capacitance vs Reverse Voltage



## ■ Outline Dimensions



DIM	INCHES		MM	
	MIN.	MAX.	MIN.	MAX.
A	0.035	0.045	0.90	1.15
A1	0.000	0.004	0.00	0.10
A2	0.035	0.041	0.90	1.05
b	0.012	0.020	0.30	0.50
c	0.004	0.008	0.10	0.20
D	0.110	0.118	2.80	3.00
E	0.047	0.055	1.20	1.40
E1	0.089	0.100	2.25	2.55
e	0.370TYP.		0.95TYP.	
e1	0.071	0.079	1.80	2.00
L	0.220REF.		0.55REF.	
L1	0.012	0.020	0.30	0.50
θ	0°	8°	0°	8°

## ■ Soldering Footprint

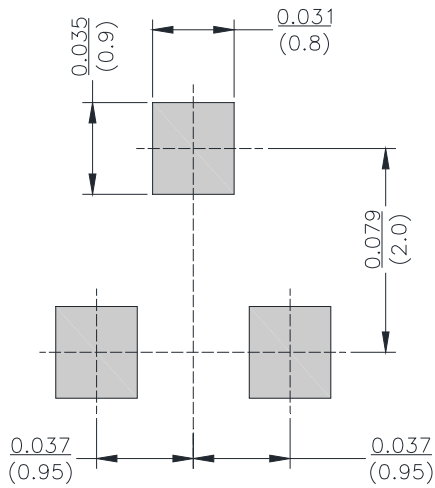

Unit:  $\frac{\text{inch}}{\text{mm}}$



## Disclaimer

The information presented in this document is for reference only. Yangzhou Yangjie Electronic Technology Co., Ltd. reserves the right to make changes without notice for the specification of the products displayed herein to improve reliability, function or design or otherwise.

The product listed herein is designed to be used with automotive electronics, are not designed for use in medical, life-saving, lifesustaining, or military, Yangjie or anyone on its behalf, assumes no responsibility or liability for any damages resulting from such improper use of sale.

This publication supersedes & replaces all information previously supplied. For additional information, please visit our website [http:// www.21yangjie.com](http://www.21yangjie.com) , or consult your nearest Yangjie's sales office for further assistance.